

DRIVER  
RIVER MOUTH  
CARIBOU

MINERAL CLAIMS

NTS 103 P/5E, 6W, 11W, 12E  
Lat. 55° 29' N Long. 129° 30' W

SKEENA M.D.

REPORT ON GEOCHEMISTRY

by

K.W. LIVINGSTONE, MSc.

July 1980

Operator: PRISM RESOURCES LTD.

Contractor: JMT SERVICES CORP.

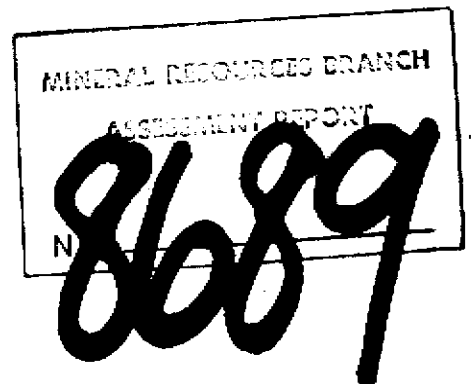

## TABLE OF CONTENTS

	<u>PAGE</u>
LOCATION AND ACCESS	1
CLAIMS	1
GEOLOGY	5
GEOCHEMISTRY	5
CONCLUSIONS	6
STATEMENT OF COSTS	7

## FIGURES

LOCATION MAPS	2, 3, 4
GEOCHEMISTRY	
MOLYBDENUM	in pocket
LEAD	
SILVER	
MANGANESE	

## LOCATION AND ACCESS

The Driver claim consists of 20 units located near the southeast shore of an unnamed lake about 2500 meters bearing 240° from the junction of Falls Creek with the Kitsault River, and about 2500 meters N 25° W from Pearson point navigation beacon, near the community of Alice Arm. The Caribou mineral claim is reverted C.G. Lot 3510. The River mouth mineral claim is reverted C.G. Lot 1074, both of which are contiguous with the Driver claim and are situated along the foreshore of Alice Arm.

The geographic coordinates of the property are approximately 129° 30.1' W 54° 28.8' N on NTS sheet 103 P/5E. Portions of the property also underlie NTS map areas 103 P/6W, 103 P/11W and 103 P/12E.

Access to the property is from Terrace or Prince Rupert by float plane to Alice Arm. Recent developments at the adjacent Kitsault mine site of Climax Molybdenum Ltd has led to the establishment of scheduled float plane service to Kitsault and the establishment of a locally based helicopter, both of which can facilitate access to the Driver claim group. Also planned, in connection with the Kitsault mine development is a road linking the mine site to Terrace. The road is however, at time of writing, in a relatively early stage of development.

Relief on the Driver claim group is about 1100 m from sea level. *Vegetation varies from dense coastal forests of Cedar and Hemlock through Mountain Balsam to Sub Alpine shrubs and trees. Slopes face southeasterly.*

## CLAIMS

Driver Rec No. 1298	20 units	Skeena M.D.
Caribou Rec. No. 1357	1 unit	Skeena M.D.
River Mouth Rec. No. 1358	1 unit	Skeena M.D.

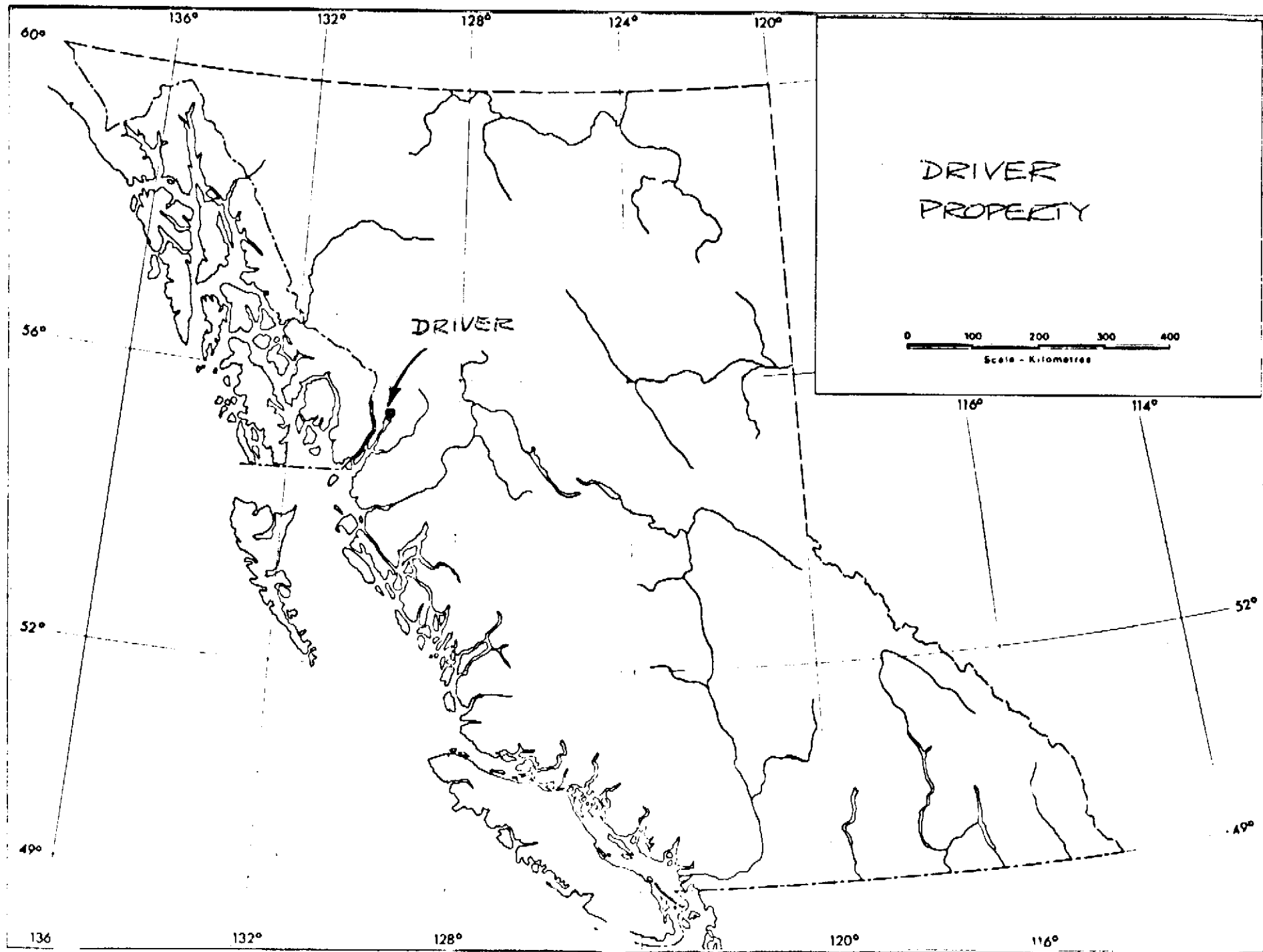

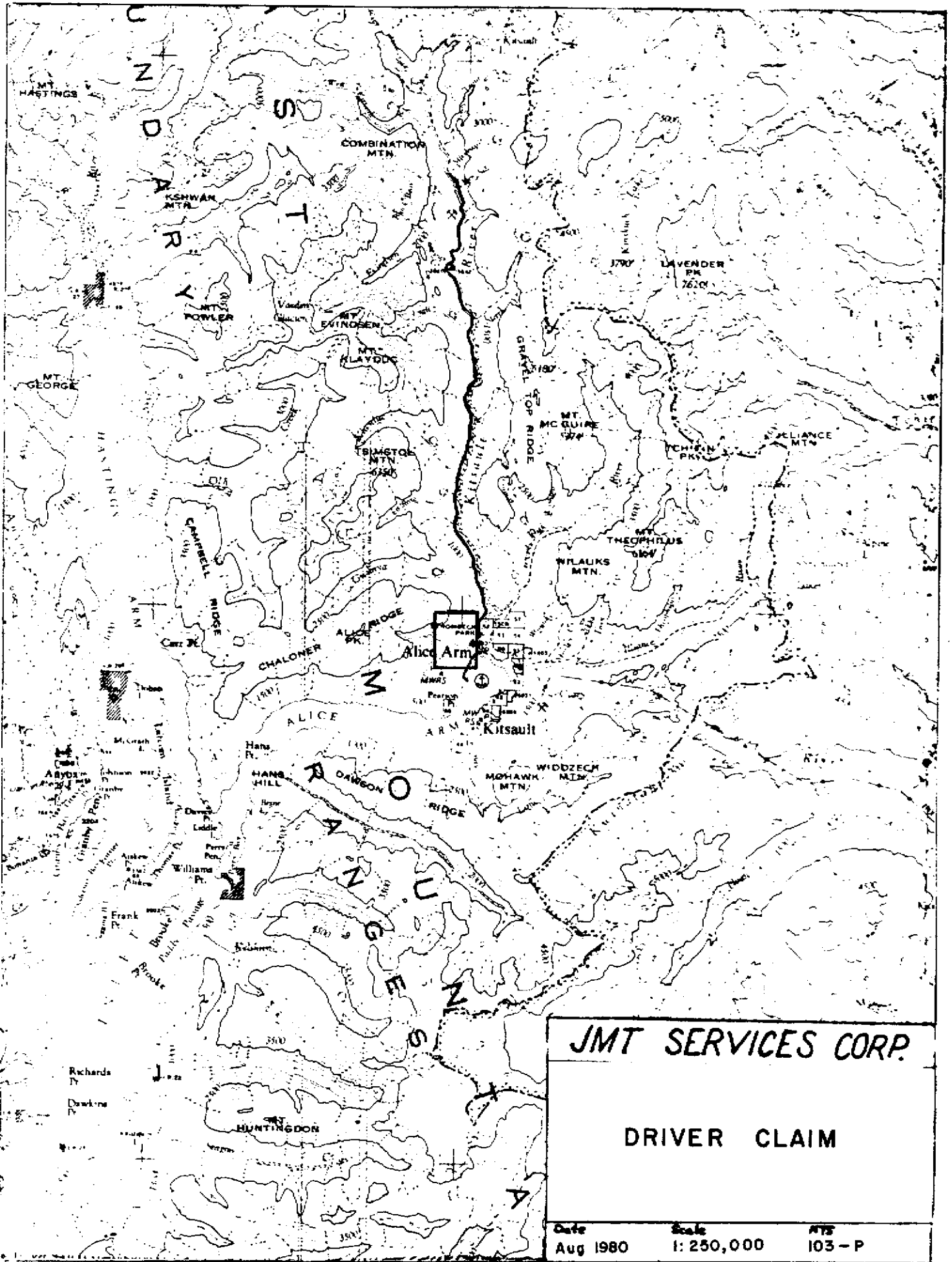

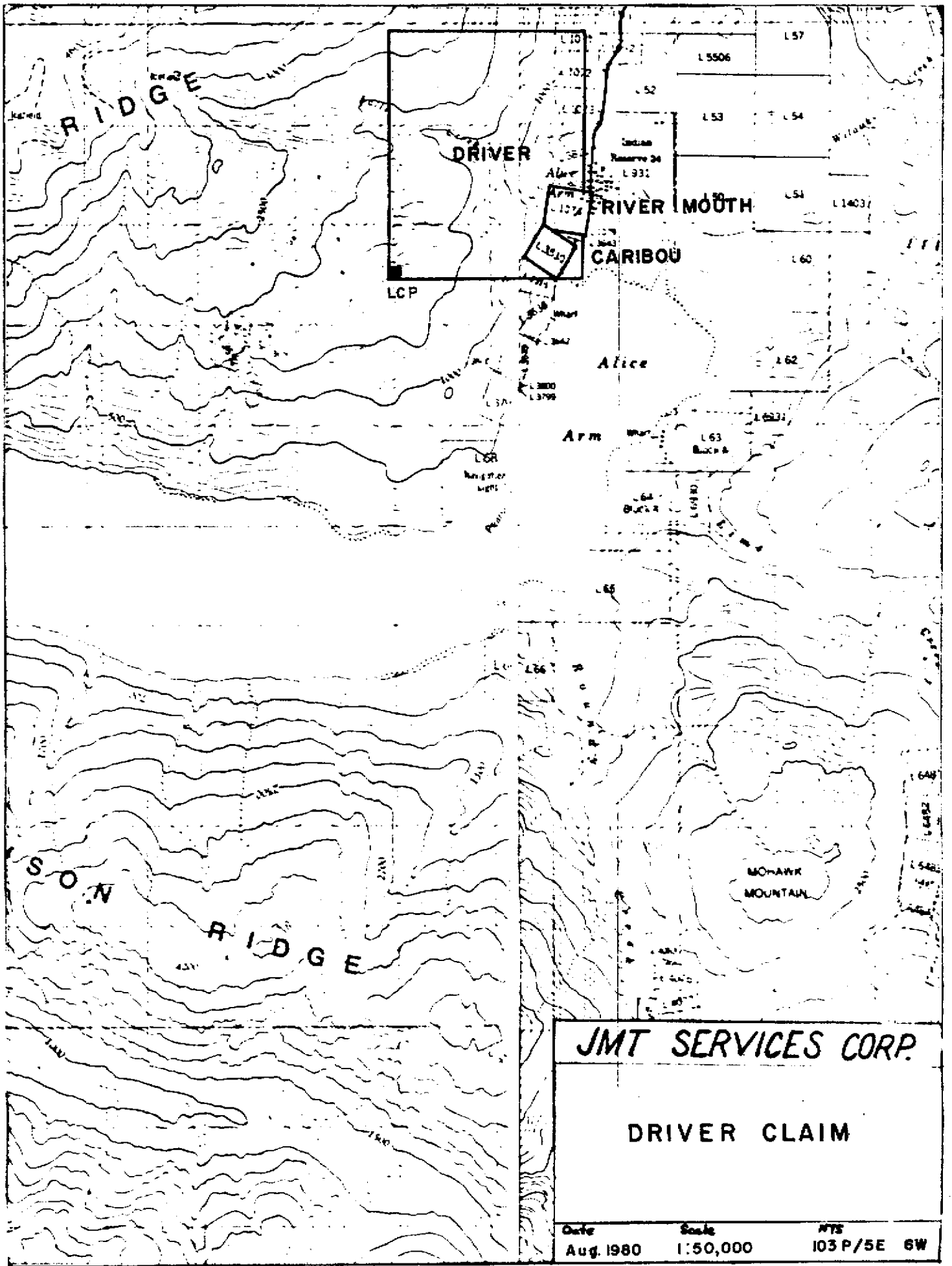

**JMT SERVICES CORP.**

**DRIVER CLAIM**

Date	Scale	NTS
Aug. 1980	1:50,000	103 P/5E 6W

## GEOLOGY

The property is underlain by argillite intruded by quartz porphyry dykes. The property has not been geologically mapped in detail.

The property is located adjacent to the Tide molybdenum prospect.

## GEOCHEMISTRY

Reconnaissance soil sample lines were run on the east-facing slope of the DRIVER claim. Samples were collected at 100 m intervals on north-south lines plus reconnaissance along Falls Creek. Samples were collected from the B soil horizon where possible and the -80 mesh fraction was geochemically assayed for Mo, Pb, Ag and Mn. The samples were analysed by Vangeochem Labs, NorthVancouver, B.C.

## RESULTS

### MOLYBDENUM:

No anomalous values were found.

### LEAD:

In general there appears to be a high background in Pb with a small anomalous zone greater than 40 ppm Pb located south of Falls Creek.

### SILVER:

Silver values form a small zone greater than 2.0 ppm adjacent to the Pb anomaly south of Falls Creek. One anomalous sample assaying 6.8 ppm was collected on the northeast part of the claim area. As no other samples were collected in this area it is uncertain as to the significance of this sample. Further sampling should be done in this area.

### MANGANESE:

Manganese forms a pronounced anomaly south of Falls Creek. The anomaly includes the Lead anomaly and overlaps the Silver anomaly.

## CONCLUSIONS AND RECOMMENDATIONS

The reconnaissance soil sampling ins this survey outlined an area anomalous in lead, silver and manganese. Because the survey was of a reconnaissance nature, the anomalous areas are not precisely outlined and further soil smapling is recommended.



STATEMENT OF COSTS

Airfares	Vancouver - Terrace 4 men (pro-rata)	150.00
Wages	2 days, 4 men @\$150.00 June 26 - 28/80	1200.00
Food	8 man days @ \$15.00	120.00
Hotel	2 days @ \$60.00	120.00
Vehicle	2 days @ \$50.00	100.00
T.P.A.	Terrace to Alice Arm return	612.00
V.I.H. helicopter		137.00
Assays		347.10
Compile results & plot data - 1 1/2 days @ \$150.00		225.00
Report		450.00
Drafting - typing - printing		<u>\$ 124.30</u>
	TOTAL:	\$3585.40

STATEMENT OF QUALIFICATIONS

I, K. WAYNE LIVINGSTONE of Vancouver, British Columbia do hereby certify that,

1. I am a Professional Geologist, working in British Columbia and residing at 6775 West Blvd. Vancouver, B.C.
2. I am a graduate of CARLETON UNIVERSITY, Ottawa, Ontario with BSc honours geology 1966.
3. I am a graduate of the UNIVERSITY OF BRITISH COLUMBIA with MSc geology 1968.
4. I have practiced my profession as a mining exploration geologist since 1965.
5. I am a Member of the Geological Association of Canada.
6. I am a Member of the CIMM.
7. This report is based on personal knowledge of the geology and mineral potential of the claim area.

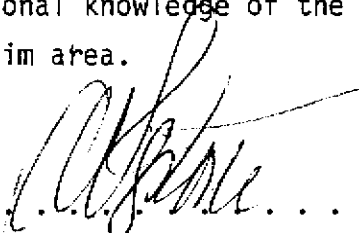
  
.....  
K. WAYNE LIVINGSTONE, MSc.

July 15, 1980

8689

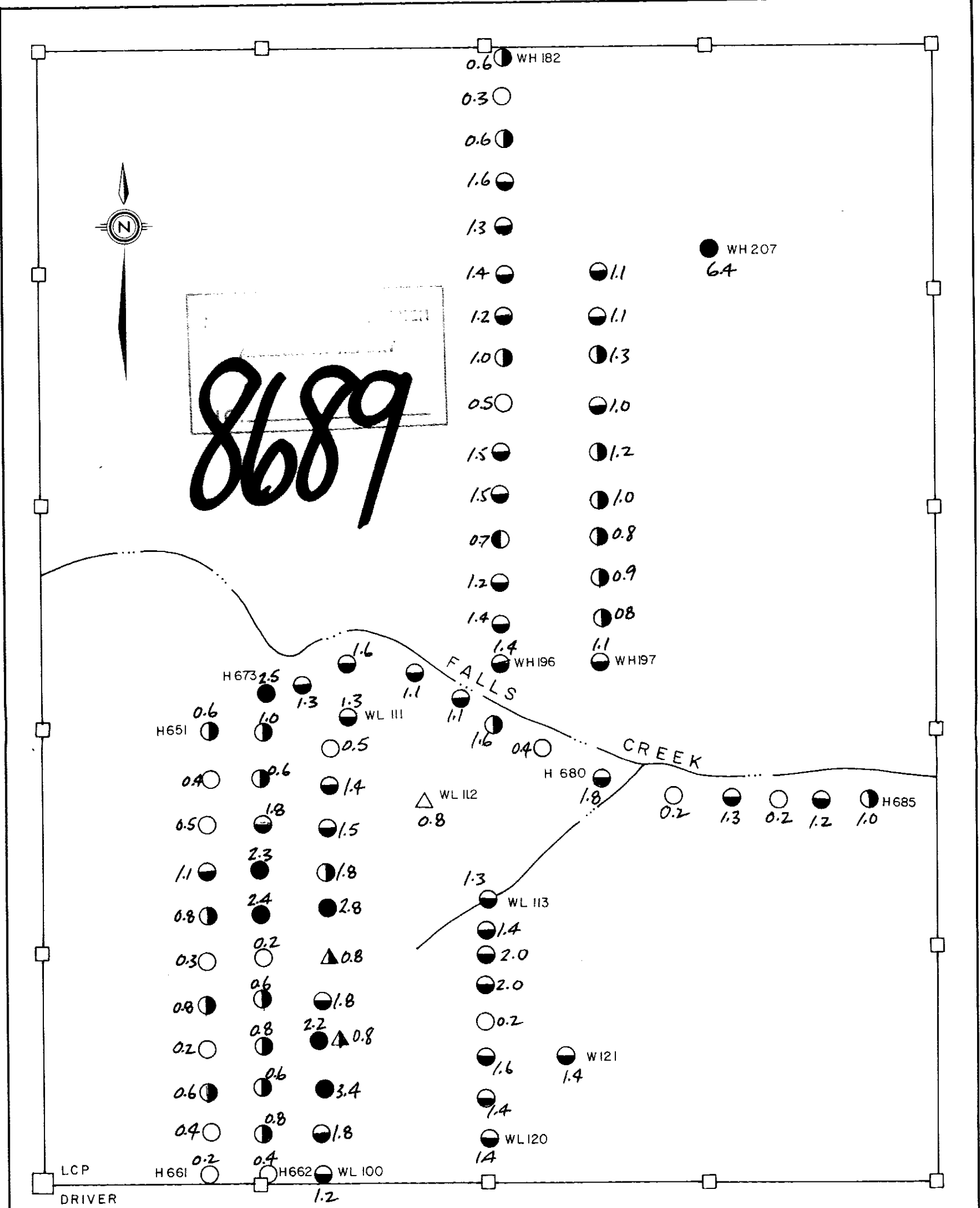

SILVER

- 0 - 0.5 ppm
- ◐ 0.6 - 1.0 ppm
- ◑ 1.1 - 2.0 ppm
- 2.0 + ppm
- Rock sample
- △ Rock chip
- H 661 Sample no.

<b>JMT SERVICES CORP.</b>		
DRIVER CLAIM <b>SILVER GEOCHEMISTRY</b>		
DATE Aug. 1980	SCALE 1:10,000 METERS 0 100 200	NTS 103 5E/6W



8689

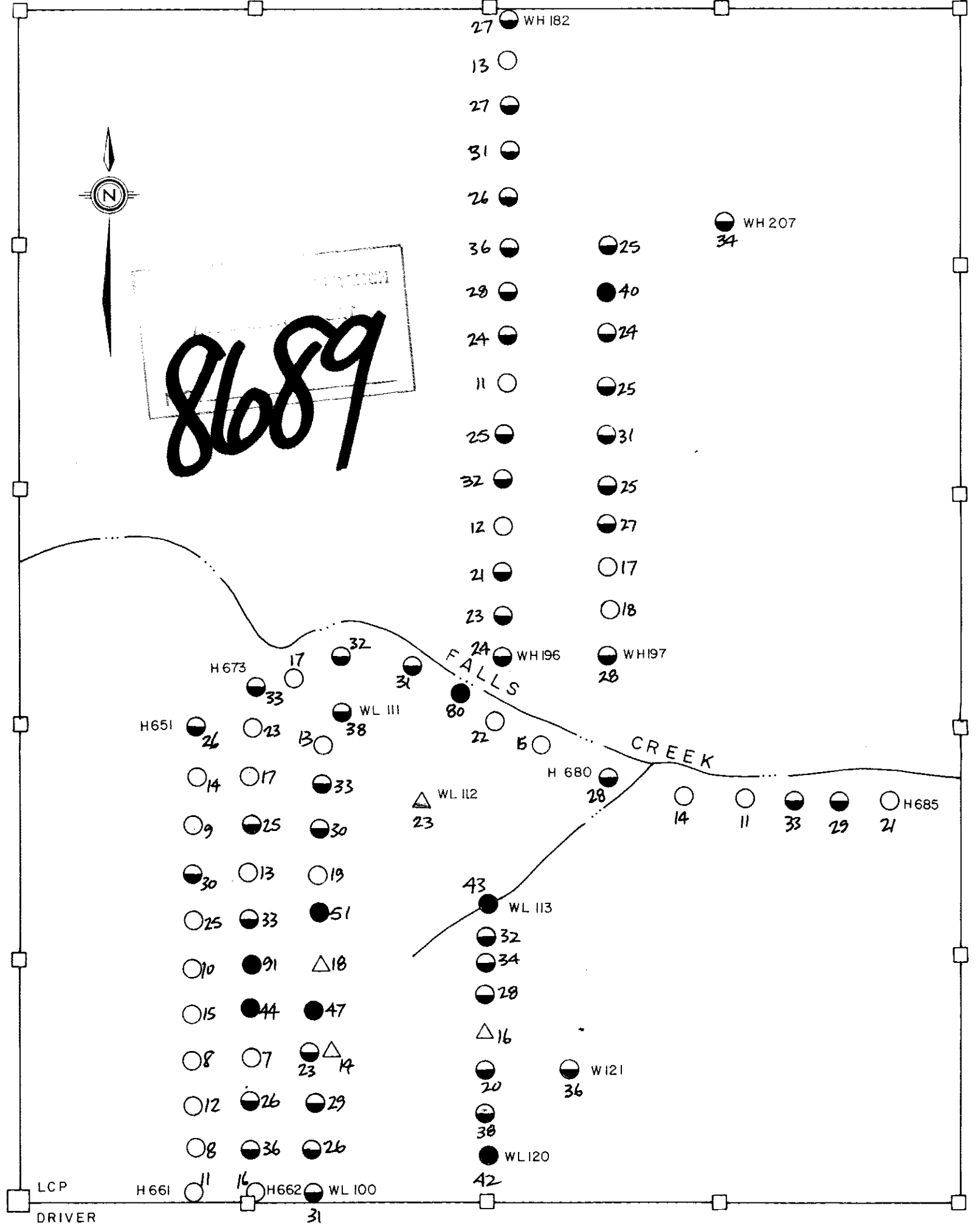

LEAD

- 0 - 20 p.p.m.
- ◐ 20 - 40 p.p.m.
- > 40 p.p.m.
- Soil sample
- △ Rock chip
- H 661 Sample no.

JMT SERVICES CORP.

DRIVER CLAIM  
LEAD GEOCHEMISTRY

DATE Aug. 1980	SCALE 1:10,000 METERS 0 100 200	NTS 103 5E/6 W
-------------------	---------------------------------------	-------------------

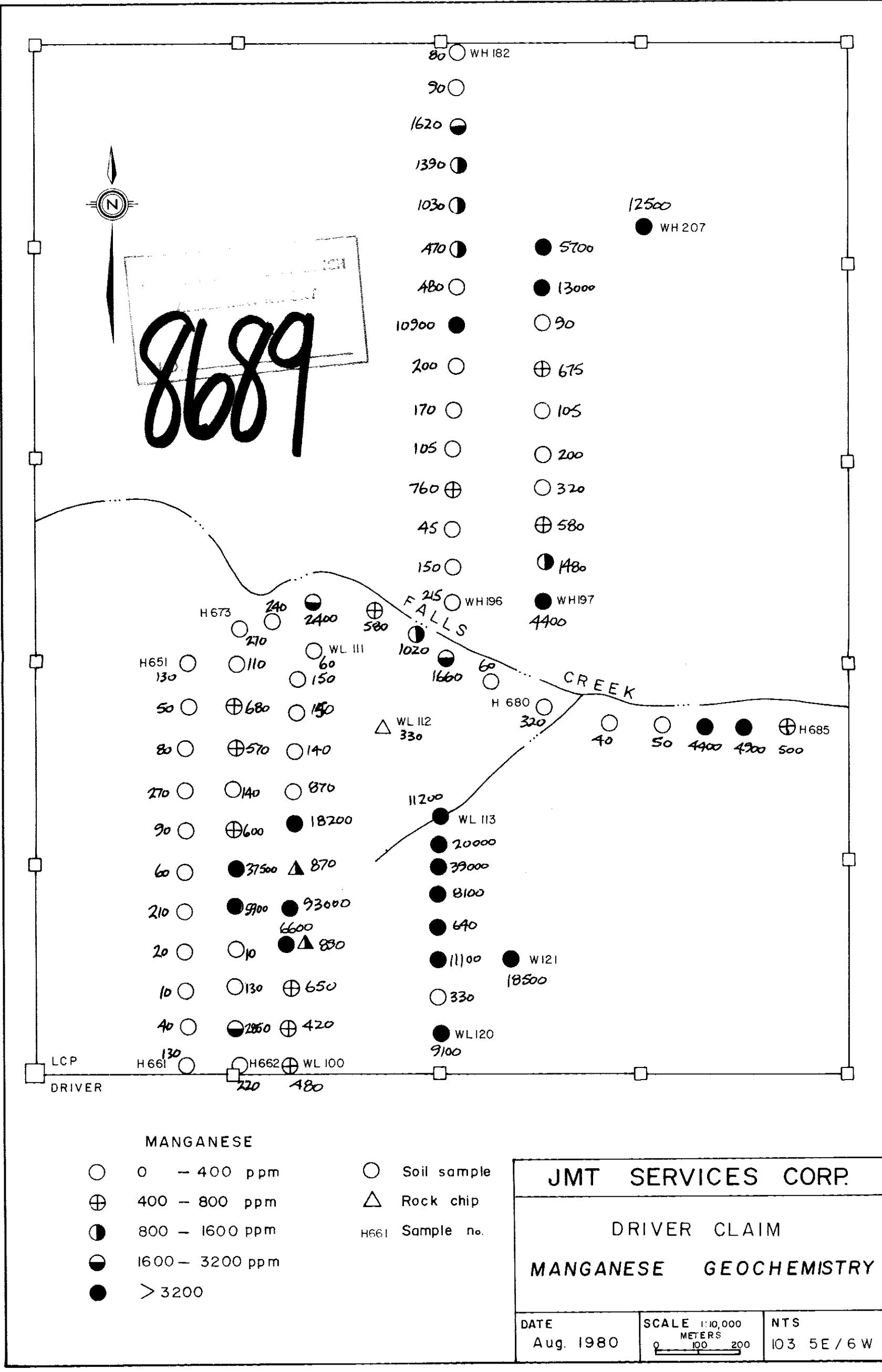

8689

**MANGANESE**

- |   |                 |      |             |
|---|-----------------|------|-------------|
| ○ | 0 - 400 ppm     | ○    | Soil sample |
| ⊕ | 400 - 800 ppm   | △    | Rock chip   |
| ◐ | 800 - 1600 ppm  | H661 | Sample no.  |
| ◑ | 1600 - 3200 ppm |      |             |
| ● | > 3200          |      |             |

<b>JMT SERVICES CORP.</b>		
<b>DRIVER CLAIM</b>		
<b>MANGANESE GEOCHEMISTRY</b>		
DATE Aug. 1980	SCALE 1:10,000 METERS 0 100 200	NTS 103 5E/6W



MINERAL REVENUE DISTRICT  
 8689

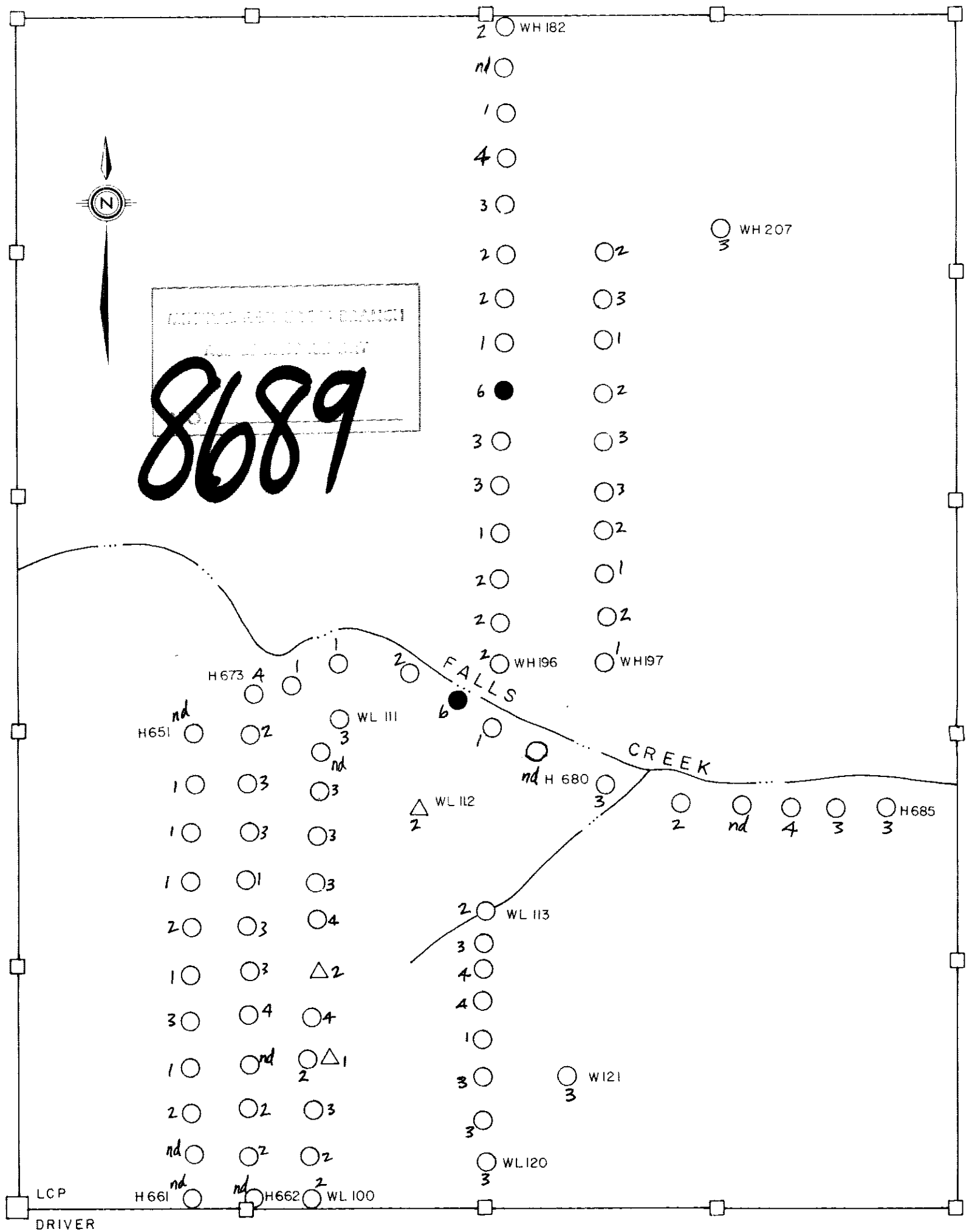

MOLYBDENUM

- 0 - 5 ppm
- 6 - 10 ppm

- Soil sample
- △ Rock chip

H 661 Sample no.

JMT SERVICES CORP.

DRIVER CLAIM  
 MOLYBDENUM GEOCHEMISTRY

DATE  
 Aug. 1980

SCALE 1:10,000  
 METERS  
 0 100 200

NTS  
 103 5 E/6 W